

# 760B

## Low Pressure Gauge • Black Finished Steel Case

SPECIALTY GAUGES



760B shown



- ▶ 2 1/2", 4" Dial Sizes
- ▶ ±1.6% Accuracy
- ▶ Drawn Steel Case

The Trerice **760B** Low Pressure Gauge is designed to accurately measure extreme low pressure conditions. This pressure gauge employs a diaphragm capsule sensing element to measure the low pressure. Case material is drawn steel with brass wetted parts.

- Optional features and case style variations available: Please consult the Options & Accessories Section for details.
- For correct use and application of all pressure gauges, please refer to: Pressure Gauge Standard ASME B40.100.

### Specifications

|                                    |   |
|------------------------------------|---|
| <b>Model</b>                       | 760B  |
| <b>Dial Sizes</b>                  | 2 1/2", 4"  |
| <b>Wetted Parts</b>                | 316L stainless steel diaphragm capsule, brass socket  |
| <b>Movement</b>                    | Brass   |
| <b>Connection</b>                  | 2 1/2" Dial Size: Lower male or center back male, 1/4 NPT<br><br>4" Dial Size: Lower male or center back male, 1/4 or 1/2 NPT |
| <b>Case</b>                        | Drawn steel, black finished, stem-mounted flangeless  |
| <b>Window</b>                      | Polycarbonate, snap-in  |
| <b>Pointer</b>                     | Plain, black finished   |
| <b>Dial Face</b>                   | Aluminum, white background with black graduations and markings  |
| <b>Accuracy</b>                    | ±1.6% Full Scale  |
| <b>Maximum Temperature</b>         | 140°F (65°C)  |
| <b>Approximate Shipping Weight</b> | 2 1/2" Dial Size:<br>0.3 lbs [0.14 kg]<br><br>4" Dial Size:<br>0.89 lbs [0.36 kg]   |

### HOW TO ORDER

Sample Order Number: **760B 25 02 L T 660**

| Model | Dial Size          | Connection Size           | Connection Location | Units of Measure       | Range Code          |
|-------|--------------------|---------------------------|---------------------|------------------------|---------------------|
| 760B  | 25 2 1/2"<br>40 4" | 02 1/4 NPT<br>04 1/2 NPT* | L Lower<br>B Back   | T Pressure<br>W Vacuum | See Standard Ranges |

\* 1/2 NPT connection size available only with 4" dial size.

# 760B

All dimensions are nominal. Dimensions in [ ] are in millimeters.

## Low Pressure Gauge • Black Finished Steel Case

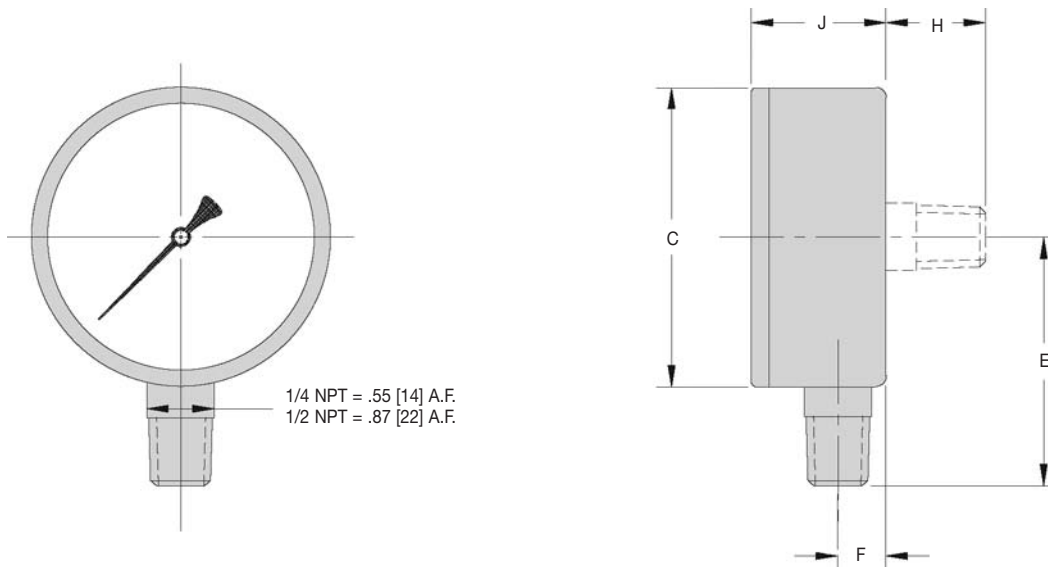

| Dial Size    | C         | E         | F          | H         | J         |
|--------------|-----------|-----------|------------|-----------|-----------|
| 2 1/2"       | 2.44 [62] | 2.20 [56] | 0.37 [9.5] | 0.98 [25] | 1.34 [34] |
| 4"           | 3.90 [99] | 3.23 [82] | 0.61 [16]  | 0.98 [25] | 1.22 [44] |
| 4" (1/2 NPT) | 3.90 [99] | 3.43 [87] | 0.61 [16]  | 1.38 [35] | 1.22 [44] |

### Standard Ranges\*

| Pressure (T) |   |                  |                 |
|--------------|---|------------------|-----------------|
| Range Code   | Specific Range  | Figure Intervals | Minor Divisions |
| 645          | 0/10 in. H <sub>2</sub> O                             | 1                | 0.1             |
| 650          | 0/15 in. H <sub>2</sub> O                             | 5                | 0.2             |
| 660          | 0/30 in. H <sub>2</sub> O                             | 5                | 0.5             |
| 670          | 0/60 in. H <sub>2</sub> O                             | 10               | 1               |
| 680          | 0/100 in. H <sub>2</sub> O                            | 10               | 1               |
| 690          | 0/160 in. H <sub>2</sub> O                            | 20               | 2               |
| 700          | 0/200 in. H <sub>2</sub> O                            | 20               | 2               |
| 720          | 0/300 in. H <sub>2</sub> O                            | 50               | 5               |
| 652          | 0/10 oz./in. <sup>2</sup>                             | 1                | 0.1             |
| 655          | 0/15 oz./in. <sup>2</sup>                             | 5                | 0.2             |
| 662          | 0/20 oz./in. <sup>2</sup> & 0/34 in. H <sub>2</sub> O | 5                | 1               |
| 667          | 0/30 oz./in. <sup>2</sup>                             | 5                | 0.5             |
| 675          | 0/60 oz./in. <sup>2</sup>                             | 10               | 1               |
| 695          | 0/100 oz./in. <sup>2</sup>                            | 10               | 1               |
| 725          | 0/160 oz./in. <sup>2</sup>                            | 20               | 2               |
| 750          | 0/250 oz./in. <sup>2</sup>                            | 50               | 5               |
| 675          | 0/3 psi   | 0.5              | 0.05            |
| 685          | 0/5 psi   | 1                | 0.1             |
| 715          | 0/10 psi  | 1                | 0.1             |

### Standard Ranges\*

| Vacuum (W) |                            |                  |                 |
|------------|----------------------------|------------------|-----------------|
| Range Code | Specific Range             | Figure Intervals | Minor Divisions |
| 580        | 15/0 in. H <sub>2</sub> O  | 5                | 0.2             |
| 600        | 30/0 in. H <sub>2</sub> O  | 5                | 0.5             |
| 610        | 60/0 in. H <sub>2</sub> O  | 10               | 1               |
| 620        | 100/0 in. H <sub>2</sub> O | 10               | 1               |
| 635        | 200/0 in. H <sub>2</sub> O | 20               | 2               |
| 595        | 15/0 oz./in. <sup>2</sup>  | 5                | 0.2             |
| 605        | 30/0 oz./in. <sup>2</sup>  | 5                | 0.5             |
| 620        | 60/0 oz./in. <sup>2</sup>  | 10               | 1               |
| 633        | 100/0 oz./in. <sup>2</sup> | 10               | 1               |

\* Compound ranges are also available. Please consult factory.

SPECIALTY GAUGES